

T845安裝說明

1.W400 x H725
2.W350 x H980

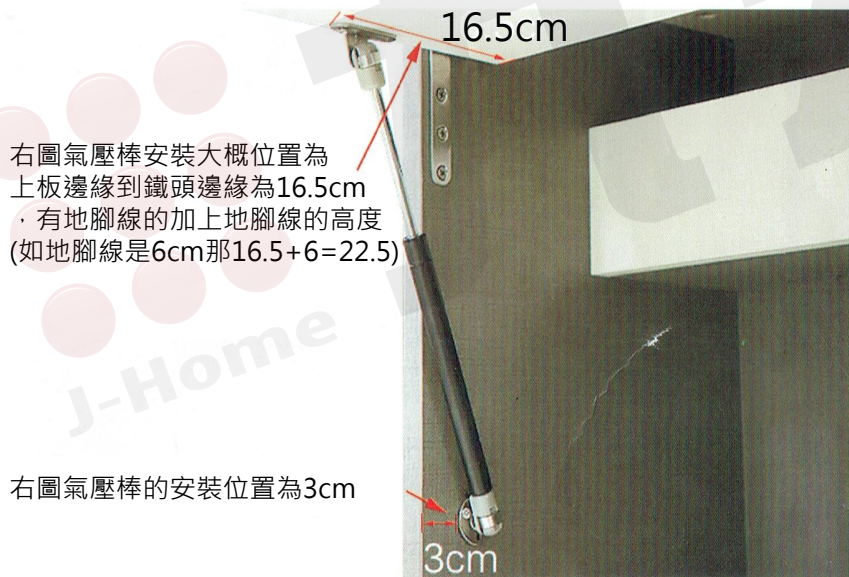

1.壁桌五金配件(不含桌板)

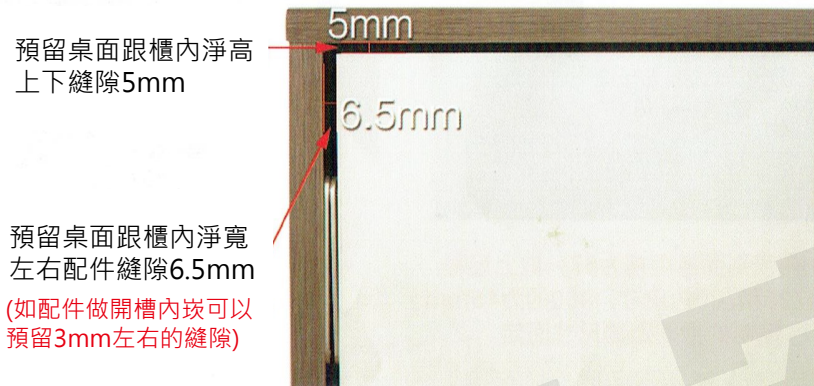

2.桌板打8mm·深度1cm



3.裝上轉軸並固定一面



4.桌腳框架放面板上·邊緣留3cm左右

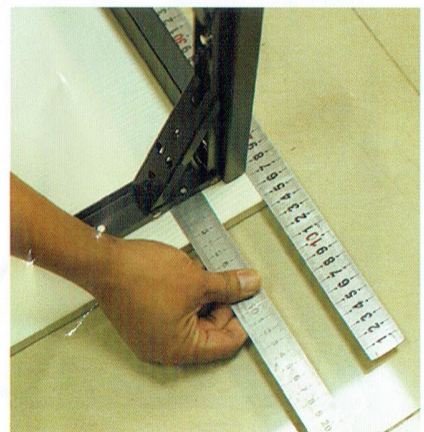

5.摺疊支架離桌板邊3cm

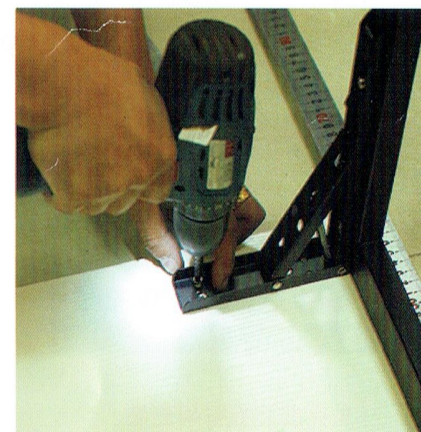

6.固定支架孔位

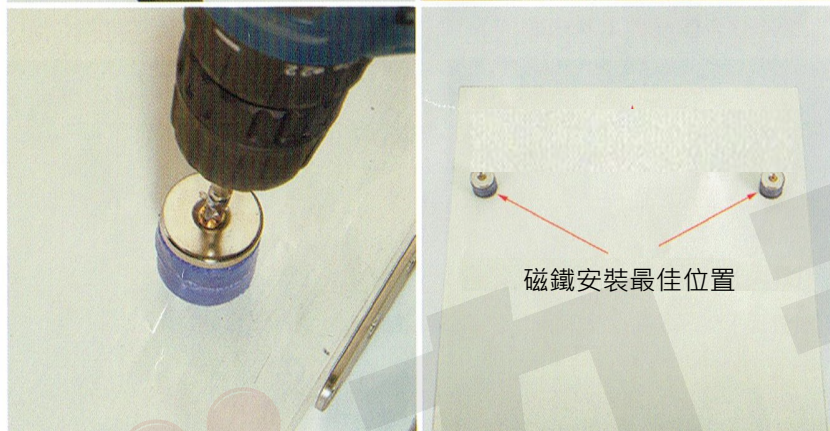
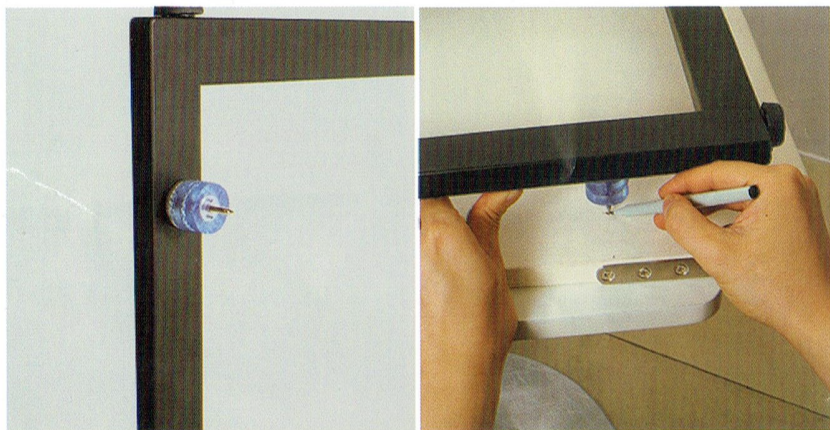

7.磁鐵做記號固定螺絲



8.完成桌腳框架安裝



轉軸位置離邊緣1~2mm間隙
25厚面板為5mm間隙

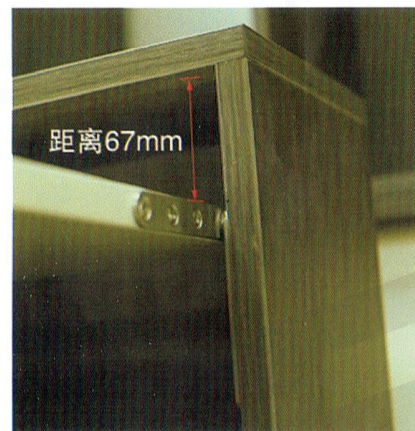

10.H725內高到桌板上方距離為67mm
(H980內高到桌板上方距離為45mm)

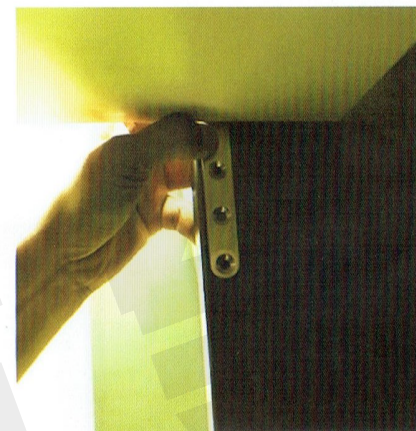

11.固定另一面轉軸

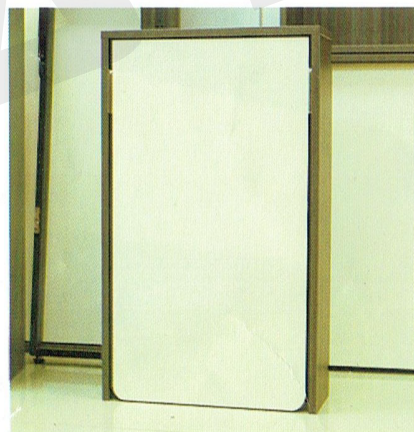

12.完成安裝



13.拍門器位置可根據實際情況
選擇側裝或地裝