

DE Montageanleitung
EN Mounting instructions
FR Instructions de montage

ES Instrucciones de montaje
RO Instrucțiuni de montare
IT Istruzioni per l'installazione

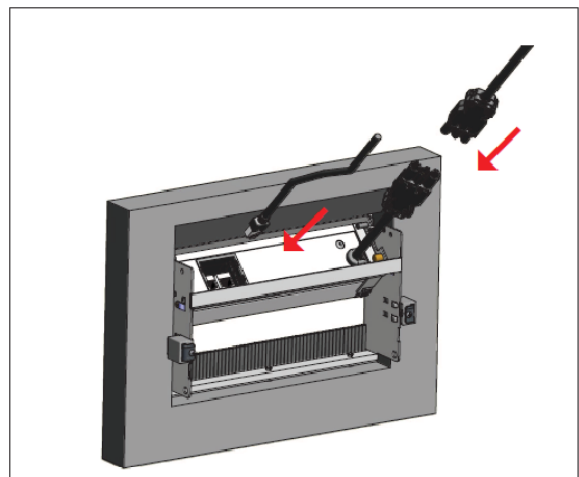

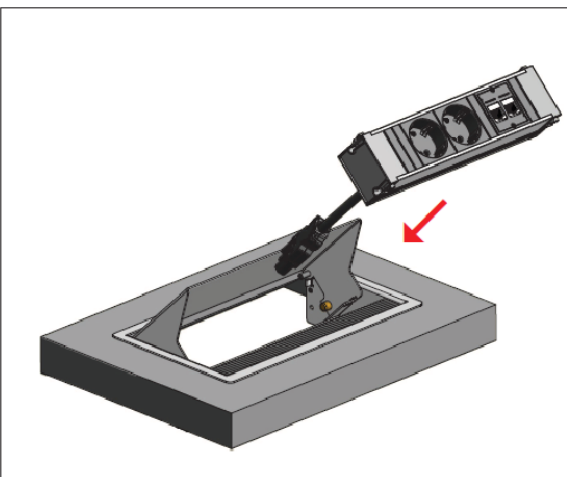
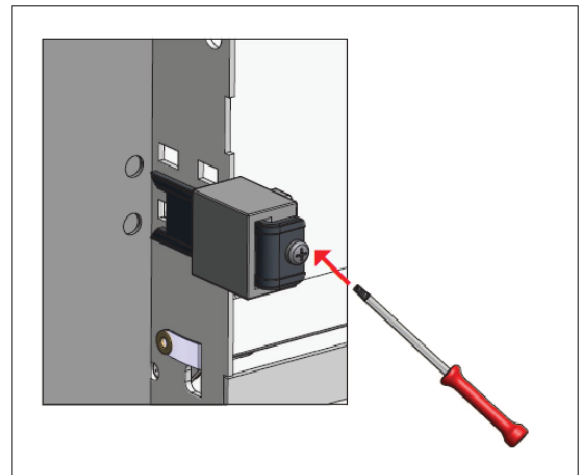
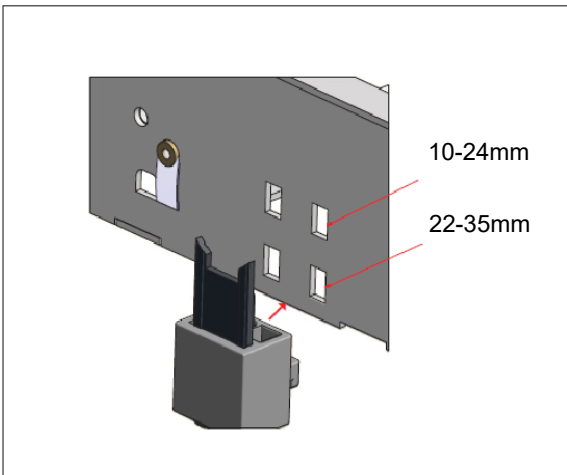
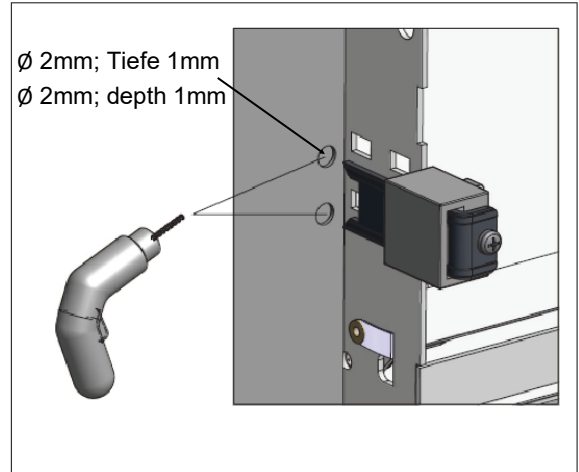
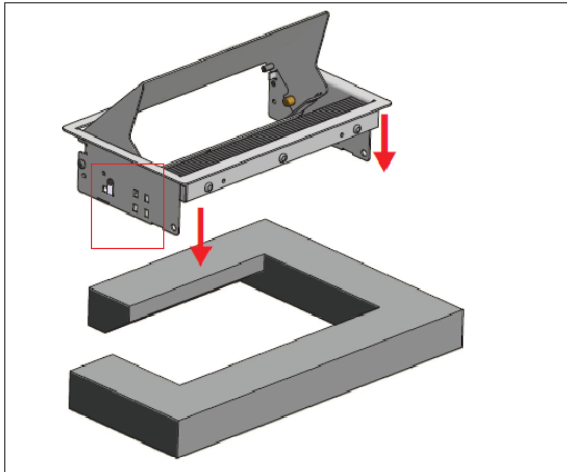
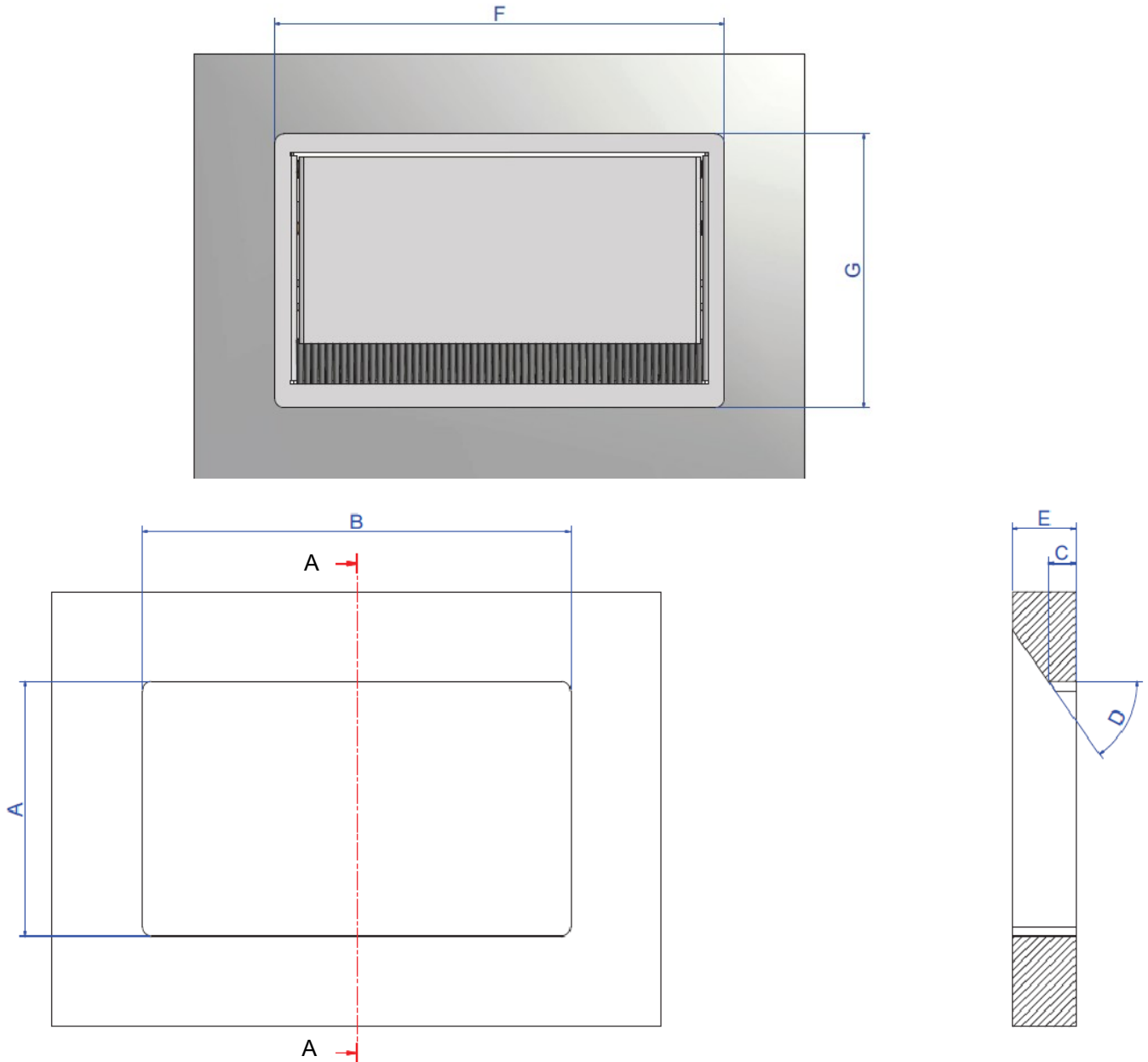

Tisch-Ausschnittmaße / Table cut-out dimensions

	A	B	C	D	E	F	G
S	138mm	230mm	15mm	55°	10-35mm	248mm	151mm
M	138mm	272,5mm	15mm	55°	10-35mm	290,5mm	151mm
L	138mm	368,5mm	15mm	55°	10-35mm	386,5mm	151mm

Achtung: Toleranz für alle A-/B-Maße = + 0,50mm

Attention: Tolerance for all A-/B-dimensions = + 0,50mm

Ausschnitt für flächenbündige
Version dem Produkt anpassen
Eckenradius 5mm

Adapt table section to product for
flush-mounted version
radius 5mm